

VILLAGE SAFETY INITIATIVE

By



**Revenue and Disaster Management Department
Government of Haryana**

**VILLAGE DISASTER MANAGEMENT PLAN
MODEL TEMPLATE
2015-16**



**CENTRE FOR DISASTER MANAGEMENT
HARYANA INSTITUTE OF PUBLIC ADMINISTRATION
GURGAON**

Village Disaster Management Plan, Mahluka

Contents

S.No.	Chapter	Page
1.	Situational Analysis of Village	3-5
2.	HRVC Assessment	6-9
3.	Response Plan	10-12
4.	Mitigation & Preparedness Plan	13-16
5.	Contact details & Updation Mechanism	17

Chapter 1: Situational Analysis of Village

1.1. Introduction

Village Profile: - a) Description of village Moda Khera is situated at Adampur on Bhana road form 12KM Adampur Tehsil.

b) Village at a glance as under

Name of Village	Moda Khera
Name of Patwari	Devi Lal
Name of Village Secretary	Sispal
Contact No. of Village Secretary	9416289246
Name of Panchayat	Moda Khera
Name of Sarpanch	Ashok
Contact No. of Sarpanch	9467592483
Name of Block	Adampur
Name of Teshil	Adampur
Name of Police Post/Station	Adampur
No. Of house holds	857
Hospitals	-
Schools	3
Industries	2
Religious Institutions	4

1.2. Population :-

Description	Person	Male	Female
Total Population	4572	2391	2181
Children	566	297	269
People with disabilities	23	14	9
Elderly/aged	323	205	118
Those who dependent upon specific medication for survival	-	-	-
Transgender	-	-	-

1.3. Temperature and rainfall

The climate is Semiarid and hot which is mainly dry with very hot summer and cold winter except during monsoon. Here experience extreme temperature ranges 5.5-45.6 degree centigrade with severe cold in month of December & January and the month of May & June are of bitter summer. The annual average rainfall in the village is 43 mm. About 70 per cent of the annual rainfall is received during period from July to September

1.4. Agricultural Land and Cropping Pattern

The total agricultural land is 3607 acres. Wheat, rice, jowar, bajra are major crops grown in the village.

Cropping Pattern at Village						
<i>Sr. No.</i>	<i>Types of Crops cultivated</i>	<i>Area cultivated (Acres)</i>	<i>Duration of Month</i>	<i>Area under Crop Insurance (Yes/No)</i>	<i>Stock facilities (Yes/No)</i>	<i>Others</i>
	Wheat	1502	6 Month	No	No	No
	Sarso	1105	6 Month	No	No	No
	Ganwar	1582	6 Month	No	No	No
	Bajra	51	3 Month	No	No	No

1.5. Drinking Water

The main source of drinking water located within premises of Village and supply of drinking water in village as per below:-

<i>Rivers/ canal</i>	<i>Tanks/ pond</i>	<i>Tube wells</i>	<i>Covered Wells</i>	<i>Uncovered Wells</i>	<i>Hand pumps</i>	<i>Water Supply by PHED</i>
	2 Tanks	-	-	-	-	Yes

1.6. Educational Institutions and Literacy Rate

Literacy rate of village is 61 percent. There is only one middle Government school in the village where children get their education. For further studies children have to go to Adampur and Hisar.

1.7. Roads and Transport

Condition of road is not so good within the village. Road from Moda Khera to Gurshal is in bad shape. For commuting, people prefer personal vehicle and private bus service.

1.8. Infrastructure details

Infrastructural Details at Village				
<i>Sr.</i>	<i>Facilities</i>	<i>Number</i>	<i>Contact Person</i>	<i>Contact Number</i>
1	PHC	1	Murthi Devi	7027829826
2	CHC	No	No	No
3	Medical Shop	2	Subhash	9813441972
4	Anganwadi centre	5	Roshani	9813386802
5	ANM	1	Murthi Devi	7027829826
6	ASHA workers	4	Saroj	7027829366
7	Pvt. Hospital	-	-	-
8	Pvt. Doctors	-	-	-
9	Veterinary doctors	-	-	-
10	Veterinary practitioners	1	Chander Singh	8053755844
11	Medical practitioners	-	-	-
12	Religious Institution	1	Chanan Mal	9416921687
1	Govt. Primary Schools	2		
Others Details of Village				
			<i>Depend upon</i>	
1	Literacy Rate		61%	
2	Education		Sen Sec School	
3	Economy of Village		Agriculture and allied activities	
4	BPL Family		238	
Household Details				
1	Total House Hold		886	
2	Kucha		17	
3	pucca		869	
4	Semi pucca		-	
5	Other critical ESTABLISHMENTS		-	

Chapter 2: Hazard, Risk, Vulnerability, Capacity Assessment

2.1 Hazard: The Hazard Profile of the Village

<i>Hazards (in and around the village)</i>	<i>Hazard Probability (High / Med / Low)</i>	<i>Possible causes</i>
Road Accidents	High	Due to bad shape of roads, On main highway
Flood	Low	Drought prone Village
Earthquake	Low	Low Risk Zone
Building collapse	Low	No Old Building
Epidemic / Contagious disease	Low	Due to unhygienic conditions
Fire	High	Short circuit, Fire in field
Heat Wave	Med	summer
Cold Wave	Med	Winters
Industrial / Chemical hazard	Med	Bricks Factory
Stampede	Low	Due to riots or violence

2.2 Vulnerability Analysis

Vulnerable groups in the village – to different hazards				
<i>Sr.</i>	<i>Name of Hazards</i>	<i>Vulnerable Area</i>	<i>Vulneable Groups</i>	<i>Facilities Affected</i>
1	Flood	All site of Village Drought Prone village	1.Old Age 2.Children below age 12 3.Women, 4.Sick Persons, 5.Below Poverty Line	1.Drainage , 2.Electricity, 3.Drinking water, 4.Road 5.Communication, 6.Govt Property, 7.Ariculture 8.Animal Losses
2	Fire	Filed Area	Farmers and their dependents	1.Electricity, 2.Crop Damage
3	Epidemics	Flood affected area and nearby	All community of village can be	Medical facilities, transport

4	Snake bite	Flood affected area and nearby	All community of village can be	Medical Facilities, transport
5	Hailstorm		Low possibility	
6	Pest Attack	Agriculture area	Can be in crops.	Crop Failure
7	Heat Wave		Village population	Medical Facilities
8	Cold Wave		Village population	Medical Facilities
9	Road Accidents	Houses Nearby Road	Road locations houses	
Other Vulnerabilities				(Impacts)
1	Social Vulnerabilities	Culture of Village can be affected	Living Pattern, Dress, Food Habits and the employment kind of village will be changed if hazard occurs	
2	Political Vulnerabilities	Political System also affect	Group Clashes, Clashes on Compensation, other interference of local group or parties.	

<i>Details</i>	<i>No. of Household</i>
Household (HH) in low lying areas	Nil
HH with poorly constructed houses	Nil
Old aged population (above 65 age)	323
Children below (0-6 age)	566
Women headed households	127
BPL population	238(92)
Landless HH	238
HH (Low income group)	238

2.3 Risk Analysis

<i>Severity</i>	<i>Hazard</i>	<i>Elements at Risk</i>	<i>Vulnerable Areas</i>
High Risk Hazards	Drought	Human Life, crop life, Cattle life,	Entire village is prone to drought like condition. Ground water depletion is

			maximum as tube wells remain the alternate source of water.
	Fires	Human Loss, cattle life, agricultural produce, kutcha houses, industries, etc.	Agricultural Land
	Road Accidents	People travelling on roof/ inside buses. on national Highways, state Highways and other district. Cattle and other animals.	HH on side of the State Highway from Adampur to Bhadra.
Medium Risk Hazards	Extreme Temperature	Human life, Cattle population, Crops, transportation activities.	Entire Village
	Floods	Human life, cattle life, crop life, property and public infrastructure.	Entire Village
	Epidemic	Human Life, animal life	Entire Village
Low risk Hazards	Frost Thunder storm Hailstorm	Crop, cattle life Human life, crop , Cattle life, Public infrastructure	People with poor housing conditions in the village.
	Terrorist Attack	Crowded places	Bus stops, Malls, Hospitals, Places of Worship, <i>Melas</i> etc in the village.
	Earthquake	Human life, cattle life, public infrastructure, environment, etc.	Entire village falls in EQ Zone- II i.e. Low damage risk zone.

2.4 Community Resources

Name of Facilities	Community Resources		
<i>Particulars</i>	<i>Total no.</i>	<i>Contact Person and Telephone Number</i>	<i>Distance from the Village</i>
Hospital	1	Civil Hospital Adampur 01669-242088	10 KM

Public health centre	1	Murti Devi 7027829826	In Village
Dispensaries	1	-	-
Veterinary Hospital	1	Chander Singh 8053755811	In village
Private Hospital	1	Civil Hospital Adampur 01669-242088	10 KM
OPD Facility	1	Civil Hospital Adampur 01669-242088	10 KM
X Ray Facility	1	Civil Hospital Adampur 01669-242088	10 KM
Ambulance service	1	Civil Hospital Adampur 01669-242088	10 KM
Medicine Shop	2	Subhash 9813441972	In village
.....			
.....			

Chapter 3: Mitigation & Preparedness Plan

This chapter will include:

3.1. Standard Operating Procedures

The teams formed in the previous chapter, their SOPs shall be listed down here. For eg:

- 3.1.1. Early Warning & Information Dissemination Team
 - Communicate the information.....
 - Update contact details of local resources/ offices, etc...
 -
 -
- 3.1.2. First Aid Team
 - Maintain list of pregnant women, infants, people with special medical needs, etc..
 - Keeping First-Aid box with disinfectants, antiseptics, ORS, etc.
 -
 -
- 3.1.3. Carcass Disposal Team
 - Stocking kerosene and fuel for disposal of carcass.
 - Maintaining storage of sackcloth to cover dead bodies of animals.
 - Proper spray of disinfectants (eg: DDT) to keep the air clean
 -
- 3.1.4. Evacuation Team
 - Keeping evacuation map of the village with them
 - Knowing the way of evacuation from the village
 - Identifying safe evacuation routes, places, assembly points in and around the village
 -
 -
- 3.1.5. Damage Assessment Team
 - Help in forecasting damages including lives lost and losses to property and assets such as houses, livestock, agriculture, plantation, etc.
 - Sensitizing families of village to keep their important documents safe, and in emergency kit.
 -
- 3.1.6. Reconstruction & Rehabilitation Team
 - Get purified water sources in village
 - Prepare reconstruction and rehabilitation plan for vulnerable groups/areas in the village
 -

3.2. Identify Safe Evacuation Routes

- Selection of evacuation route that minimize the exposure to the hazard and other obstacles
- Evacuation route to be easily accessible even for vulnerable groups such as, women, children, and elderly.

Evacuation Map of the village

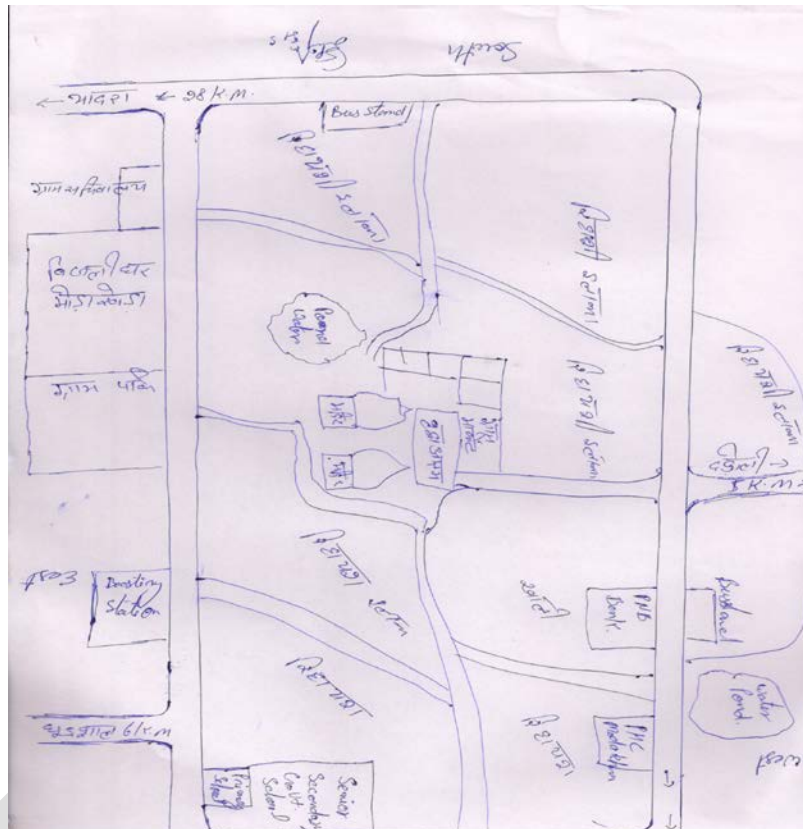

3.3. Community level Mitigation Programme

Include hazard specific mitigation measures and schemes running in the village

3.3.1. Flood Mitigation

- Construction of flood shelter
- Drainage channels to be cleared
- Construction of raised platforms near important/ vulnerable areas, such as school, shelter of animals, gaushalas, etc.
-
-

3.3.2. Earthquake Mitigation

- Detailed survey of buildings for assessment of damage and repair/ reconstruction and seismic strengthening or demolition
- Training the local masons for constructing earthquake resistant structures
- Conducting mock drills in villages for evacuation during an earthquake

- Fix all objects in houses that can fall and cause injury (non structural mitigation....)

-
-

3.3.3. Drought Mitigation

- Continuous drought monitoring through rainfall situation, water availability in reservoirs, rivers, canals, etc. and comparing with existing water needs of society.
- Water conservation through rainwater harvesting in houses and farmers' fields
- Allowing runoff water from all fields to a common point (eg: pond) or allowing it to infiltrate in the soil where it has fallen
- Generating awareness among the village people on implementing water conservation and agriculture awareness programs through television, pamphlets, nukkad natak, etc.

-
-

3.4. Schemes & Disaster Mitigation

Identify the schemes/ projects running in the village and segregate them relevant to Mitigation and Preparedness measures. For eg:

- NREGA(for drought protection works in the village
- IAY(earthquake resistance building also protecting from cold and heat waves)
- Pradhan Mantri Gram Sadak Yojana(for prompt response and resource mobilization)
- Rural Water Supply Programme
- Total Sanitation Campaign(preventing epidemic like situation)
- Rural Connectivity Programme(economic development of agriculture sector and allied activities in the villages)

Chapter 4: Response Plan

3.1 Village Disaster Management Committee :- to carry out disaster management activities i.e. village disaster management plan, **training** and awareness activities, identification of resources and search & rescue activity at village level conducted by Village Disaster Management Committee. The following is the suggestive list of committee members:-

Village Disaster Management Committee

Sr. No.	Name	Designation	Name	Contact No.
i.	Sarpanch	Chairman	Ashok	9467592483
ii.	Village Secy	Nodal Officer	Sispal	9416289246
iii.	Patwari	Member	Devi Lal	
iv.	Numberdar	Member	Rajesh	9991311878
v.	SC Panch	Member	Renu	8683022440
vi.	BC Panch	Member	Prem Kumar	9467101448
vii.	Women (Mahila) Punch	Member	Shakuntla	9991432420
viii.	Anganwadi Worker	Member	Roshani	9813386802
ix.	SHG Heads	Member	Santosh	
x.	School Representatives	Member		
xi.	Ex-servicemen	Member	Mange Ram	8059727188

1. Village Secretary or Patwari should be Nodal Officer for Disaster Management plan of respective village
2. VDMC should conduct meetings/ Gram Sabha for planning for Disaster Management Teams, HRVC and mitigation issues, preparedness issue, relief distribution sites, rehabilitation plans other plan related issues.
3. Village Secy shall document the plan and VDMC shall approve the plan and submit it to the BDPO Office.
4. BDPO should make a copy of the plan and submit it to ADC Office after Compilation of the plans.
5. Further, Funds may be send to BDPO for conducting capacity building trainings at village level for VDMC and teams under VDMC and send the utilization certificate to this office.
6. RO along with BDPO shall arrange training program along with officers/ trainers from Fire Department/ Red Cross/ Revenue department/ civil defence.

3.2 Administrative control

<i>Designation</i>	<i>Contact Number</i>	<i>Contact Address</i>
Deputy Commissioner	232045, 233928	Hisar
SP	01662-232307	Hisar
ADC	232692, 241035,	Hisar
SDM	232798	Hisar
BDPO	9996782602	DBPO Office Adampur
Police Officer SHO	100	Adampur
Village Secretary	9416289246	Sishpal
Gram Pradhan	9467592483	Ashok
BEO		
Fire Officer	01669-242090	Adampur
SMO	01669-242088	Adampur

3.3 Members of Village Disaster Management Teams (VDMT)

S. No.	Name	Designation	Contact Number	Contact Address
Early Warning and Information Dissemination Team				
1	Ashok	Sarpanch	9467592483	Modakhera
2	Sispal	Village Secy	9416289246	Adampur
3	Devi Lal	Patwari		Adampur
4	Rajesh	Numberdar	9991311878	Modakhera
Evacuation Team				
1	Renu	Member	8683022440	Modakhera
2	Prem Kumar	-do	9467101448	Modakhera
3	Shakuntla	-do	9991432420	Modakhera
4	Rajesh	Numberdar	9991311878	Modakhera
Search and Rescue Team				
1	Roshani	A/W	9813386802	Modakhera
2	Santosh	SHG Head		Modakhera

3	Mange Ram	Ex Serviceman	8059727188	Modakhera
First Aid Team				
1	Subhash	Medical Shop	9813441972	Modakhera
2	Roshani	Anganwadi centre	9813386802	Modakhera
3	Murti Devi	ANM	7027829826	Modakhera
3	Saroj	ASHA workers	7027829366	Modakhera
4	Subhash	Medical Shop	9813441972	Modakhera
Relief Management Team				
1	Sispal	Village Secy	9416289246	Adampur
2	Devi Lal	Patwari		Modakhera
3	Roshani	A/W	9813386802	Modakhera
Sanitation Team				
1	Renu	Member	8683022440	Modakhera
2	Prem Kumar	-do	9467101448	Modakhera
3	Shakuntla	-do	9991432420	Modakhera
Shelter Management Team				
1	Renu	Member	8683022440	Modakhera
2	Prem Kumar	-do	9467101448	Modakhera
3	Shakuntla	-do	9991432420	Modakhera
Damage & Need Assessment Team				
1	Ashok	Sarpanch	9467592483	Modakhera
2	Sispal	Village Secy	9416289246	Modakhera
3	Devi Lal	Patwari		Modakhera
Rehabilitation & Reconstruction Team				
1	Renu	Member	8683022440	Modakhera
2	Prem Kumar	-do	9467101448	Modakhera
3	Shakuntla	-do	9991432420	Modakhera

3.4 Contact Details of Emergency Resource Owners/ Practitioners [Private], elected Panches in the Village Panchayat:

No.	Name	Practise/Resource	Telephone No.	Mobile No.
1	Jagdish	JCB		9466330910
2	-do	Tractor trolley		-do-
3	Mukesh	PICK-UP		9416589670

3.5 Village level Skilled persons

Name	Expertise	Address	Telephone #
Mahender	Khathi	Moda Khera	9671655687
Leelu Ram	Lohar	Moda Khera	
Hanuman	Swimmer	Moda Khera	9992860143
Pardeep	Boxer	Moda Khera	9050460636

Chapter 5: Contact details & Updation Mechanism

- 5.1.** List out the important personnel whose contact details have to be included in the plan
- The contact details from 'Chapter –4 Response Plan' will be updated
- 5.2. Updation Mechanism**
- Discuss with the village people about whose responsibility is it to update the plan.
 - The period in which the VDMP shall be updated regularly.
 - It should be taken care that the VDMP should be simple otherwise it will not be understood, and disseminated else it will not reach the needful.
 - The VDMP should be revised regularly otherwise it will not be up to date.