

# Village Disaster Management Plan

## HISAR



**Government Of Haryana**  
Department of Revenue & Disaster Management



kohli  
2015-16



**HARYANA INSTITUTE OF PUBLIC ADMINISTRATION**

**Plot 76, HIPA Complex, Sector 18, Gurgaon**

# Village Disaster Management Plan, kohli, Block Adampur, Hisar

---

## Contents

S.No.	Chapter	Page
1.	<b>Situational Analysis of Village</b>	<b>3-5</b>
2.	<b>HRVC Assessment</b>	<b>6-9</b>
3.	<b>Response Plan</b>	<b>10-12</b>
4.	<b>Mitigation &amp; Preparedness Plan</b>	<b>13-16</b>
5.	<b>Contact details &amp; Updation Mechanism</b>	<b>17</b>

# Chapter 1: Situational Analysis of Village

## 1.1. Introduction

**Village Profile:** - a) Description of village:-

Village Adampur is situated 0.5 KM from Block Headquarter, Village is surrounded by the village Mandi Adampur and Kalirawan on Agroha to Bhadra Road.

b) Village at a glance as under

<b>Name of Village</b>	Kohli
<b>Name of Patwari</b>	Shubhash
<b>Name of Village Secretary</b>	Devender
<b>Contact No. of Village Secretary</b>	9416605862
<b>Name of Panchayat</b>	Gram Panchyat kohli
<b>Name of Sarpanch</b>	Nirmla rani
<b>Contact No. of Sarpanch</b>	9992152799
<b>Name of Block</b>	Adampur
<b>Name of Teshil</b>	Adampur
<b>Name of Police Post/Station</b>	Mandi Adampur
<b>No. Of house holds</b>	900
<b>Hospitals</b>	1
<b>Schools</b>	4
<b>Industries</b>	5
<b>Religious Institutions</b>	2

## 1.2. Population :-

<i>Description</i>	<i>Person</i>	<i>Male</i>	<i>Female</i>
Total Population	4288	2286	2002
Children	552	232	220
People with disabilities	10	6	4
Elderly/aged	253	153	100
Those who dependent upon specific medication for survival	120	70	50
Transgender	-	--	--

### 1.3. Temperature and rainfall

The climate is Semiarid and hot which is mainly dry with very hot summer and cold winter except during monsoon. Here experience extreme temperature ranges 5.5-45.5 degree centigrade with severe cold in month of December & January and the month of May & June are of bitter summer. The annual average rainfall in the village is 43 mm. About 70 per cent of the annual rainfall is received during period from July to September.

### 1.4. Agricultural Land and Cropping Pattern

The total agricultural land is 1800 Acers. Wheat , cotton, Gum, Majra are major crops grown in the village.

<b>Cropping Pattern at Village</b>						
<i>Sr. No.</i>	<i>Types of Crops cultivated</i>	<i>Area cultivated (Hectare)</i>	<i>Duration of Month</i>	<i>Area under Crop Insurance (Yes/No)</i>	<i>Stock facilities (Yes/No)</i>	<i>Others</i>
1	Wheat	827	Dec-april	--	--	Yas
2	Rice	-	-	-	-	-
3	Channa & jo	1189	Nov-April	-	-	-

### 1.5. Drinking Water

The main source of drinking water located within premises of Village and supply of drinking water in village as per below:-

<i>Rivers/canal</i>	<i>Tanks/pond</i>	<i>Tube wells</i>	<i>Covered Wells</i>	<i>Uncovered Wells</i>	<i>Hand pumps</i>	<i>Water Supply by PHED</i>
1 canal	2	70	-	--	-	Yes

### 1.6. Educational Institutions and Literacy Rate

Literacy rate of village is 48 percent. There is Govt. High Schools and senior secondary school in the village and 3 private schools, where children get their education. For further studies children have to go to Mandi Adampur or Hisar.

### 1.7. Roads and Transport

Situation of road is good within the Village, the condition of road is good out side of the village and connectivity with Adampur, Agroha and Hisar is good. For commuting, people prefer Train, motorcycles, bus and govt. bus service.

**Infrastructure details**

<b>Infrastructural Details at Village</b>				
<i>Sr.</i>	<i>Facilities</i>	<i>Number</i>	<i>Contact Person</i>	<i>Contact Number</i>
<b>1</b>	PHC	1	Suresh kumar	<b>9255490917</b>
<b>2</b>	CHC	-	-	-
<b>3</b>	Medical Shop	2	<b>Rmniwas Rishal singh</b>	<b>9466005910</b>
<b>4</b>	Anganwadi centre	5	<b>Chameli devi</b>	7027829987
<b>5</b>	ANM	2	Sharda saroj	7027829987
<b>06</b>	ASHA workers	2	<b>Geeta manju</b>	<b>9466204817</b>
<b>7</b>	Pvt. Hospital	-	-	-
<b>8</b>	Pvt. Doctors	-	-	-
<b>9</b>	Veterinary doctors	1	<b>Narsi</b>	<b>9896011018</b>
<b>10</b>	Veterinary practitioners	-	-	-
<b>11</b>	Medical practitioners	--	--	--
<b>12</b>	Religious Institution	4	<b>Lalchand ramkumar</b>	-
<b>1</b>	Govt. Primery Schools	3	<b>Ghisaram bhura ram</b>	<b>9916353501</b>
<b>Others Details of Village</b>				
			<i>Depend upon</i>	
<b>1</b>	Literacy Rate		60%	
<b>2</b>	Education		70%	
<b>3</b>	Economy of Village		Medil	
<b>4</b>	BPL Family		147	
<b>Household Details</b>				
<b>1</b>	<b>Total House Hold</b>		<b>900</b>	
<b>2</b>	<b>Kucha</b>		<b>50</b>	
<b>3</b>	<b>pucca</b>		<b>550</b>	
<b>4</b>	<b>Semi pucca</b>		<b>300</b>	
<b>5</b>	<b>Other critical ESTABLISHMENTS</b>		<b>--</b>	

## Chapter 2: Hazard, Risk, Vulnerability, Capacity Assessment

### 2.1 Hazard: The Hazard Profile of the Village

<i>Hazards (in and around the village )</i>	<i>Hazard Probability (High / Med / Low)</i>	<i>Possible causes</i>
Road Accidents	Med	Due to bad shape of road
Flood	Med	Flood Prone Area, Low laying area
Earthquake	Low	As per risk Zonation
Building collapse	-	No critical building in the village
Epidemic / Contagious disease	Medium	No hygienic conditions
Fire	High	Short circuit, Fire in field, Crop Fire in summer
Heat Wave	Medium	Summer Season
Cold Wave	Medium	Winters Season
Industrial / Chemical hazard	No	Nil
Stampede	Low	No such condition

### 2.2 Vulnerability Analysis

<b>Vulnerable groups in the village – to different hazards</b>				
<i>Sr.</i>	<i>Name of Hazards</i>	<i>Vulnerable Area</i>	<i>Vulneable Groups</i>	<i>Facilities Affected</i>
1	Flood	Village prone to flash flood only	Old age people Sick People Children Women	1.Drainage , 2.Electricity, 3.Drinking water, 4.Road 5.Communication, 6.Govt Property, 7.Ariculture 8.Animal Losses
2	Fire	Filed Area	Farmers and their dependents	1.Electricity, 2.Crop Damage
3	Epidemics	Flood affected area and nearby	All community of village can be	Medical facilities, Transport
4	Snake bite	Flood affected area	All community of village can be	Medical Facilities,

		and nearby		Transport
5	Hailstorm		Medium possibility	
6	Pest Attack	Agriculture area	Can be in crops. Farmer will be affected	Crop Failure
7	Heat Wave		Village population	Medical Facilities
8	Cold Wave		Village population	Medical Facilities
9	Road Accidents		115 Houses	
<b>Other Vulnerabilities</b>				<b>( Impacts)</b>
1	<b>Social Vulnerabilities</b>	Culture of Village can be affected	Living Pattern, Dress, Food Habits and the employment kind of village will be changed if hazard occurs	
2	<b>Political Vulnerabilities</b>	Political System also affect	Group Clashes, Clashes on Compensation, other interference of local group or parties.	

<i>Details</i>	<i>No. of Household 900</i>
<b>Household (HH) in low lying areas</b>	Nil
<b>HH with poorly constructed houses</b>	50
<b>Old aged population (above 65 age)</b>	253
<b>Children below (0-6 age)</b>	552
<b>Women headed households</b>	175
<b>BPL population</b>	147
<b>Landless HH</b>	450
<b>HH (Low income group)</b>	Nil

### 2.3 Risk Analysis

<i>Severity</i>	<i>Hazard</i>	<i>Elements at Risk</i>	<i>Vulnerable Areas</i>
<b>High Risk Hazards</b>	<b>Earthquake</b>	Human life, cattle life, public infrastructure, environment, etc.	Entire village falls in EQ Zone- II i.e. Low damage risk zone.
	<b>Fires</b>	Human Loss, cattle	Agricultural Land

		life, agricultural produce, kutcha houses, industries, etc.	
	<b>Road Accidents</b>	People travelling on roof/ inside buses. on national Highways, state Highways and other district. Cattle and other animals.	School and College going students.
<b>Medium Risk Hazards</b>	<b>Extreme Temperature</b>	Human life, Cattle population, Crops, transportation activities.	Entire village
	<b>Floods</b>	Human life, cattle life, crop life, property and public infrastructure.	Entire village
<b>Low risk Hazards</b>	<b>Drought</b>	Human Life, crop life, Cattle life,	Entire village is prone to drought like condition. Ground water depletion is maximum as tube wells remain the alternate source of water.
	<b>Frost Thunder storm Hailstorm</b>	Crop, cattle life Human life, crop , Cattle life, Public infrastructure	People with poor housing conditions in the village.

#### 2.4 Community Resources

Name of Facilities	Community Resources		
<i>Particulars</i>	<i>Total no.</i>	<i>Contact Person and Telephone Number</i>	<i>Distance from the Village</i>
Hospital	1	9255490217	0km
Public health centre	1	9255490917	500m
Dispensaries	--	--	--
Veterinary Hospital	1	9896011068	500m
Private Hospital	1	General Hospital Adampur	1KM



		01669-242088	
OPD Facility	1	AMC, Agroha 281194	19KM
X Ray Facility	1	General Hospital Adampur  01669-242088	1KM
Ambulance service	1	General Hospital Adampur  01669-242088	1KM
Medicine Shop	1	Bala ji medical hall krishan singh 9466005910	3acer

DRAFT

# Chapter 3: Mitigation & Preparedness Plan

---

This chapter will include:

## **3.1. Standard Operating Procedures**

The teams formed in the previous chapter, their SOPs shall be listed down here. For eg:

- 3.1.1. Early Warning & Information Dissemination Team
  - Communicate the information.....
  - Update contact details of local resources/ offices, etc...
- 3.1.2. First Aid Team
  - Maintain list of pregnant women, infants, people with special medical needs, etc..
  - Keeping First-Aid box with disinfectants, antiseptics, ORS, etc.
- 3.1.3. Carcass Disposal Team
  - Stocking kerosene and fuel for disposal of carcass.
  - Maintaining storage of sackcloth to cover dead bodies of animals.
  - Proper spray of disinfectants (eg: DDT) to keep the air clean
  -
- 3.1.4. Evacuation Team
  - Keeping evacuation map of the village with them
  - Knowing the way of evacuation from the village
  - Identifying safe evacuation routes, places, assembly points in and around the village
- 3.1.5. Damage Assessment Team
  - Help in forecasting damages including lives lost and losses to property and assets such as houses, livestock, agriculture, plantation, etc.
  - Sensitizing families of village to keep their important documents safe, and in emergency kit.
  -
- 3.1.6. Reconstruction & Rehabilitation Team
  - Get purified water sources in village
  - Prepare reconstruction and rehabilitation plan for vulnerable groups/areas in the village

### 3.2. Identify Safe Evacuation Routes

- Selection of evacuation route that minimize the exposure to the hazard and other obstacles
- Evacuation route to be easily accessible even for vulnerable groups such as, women, children, and elderly.

*Evacuation Map of the village*

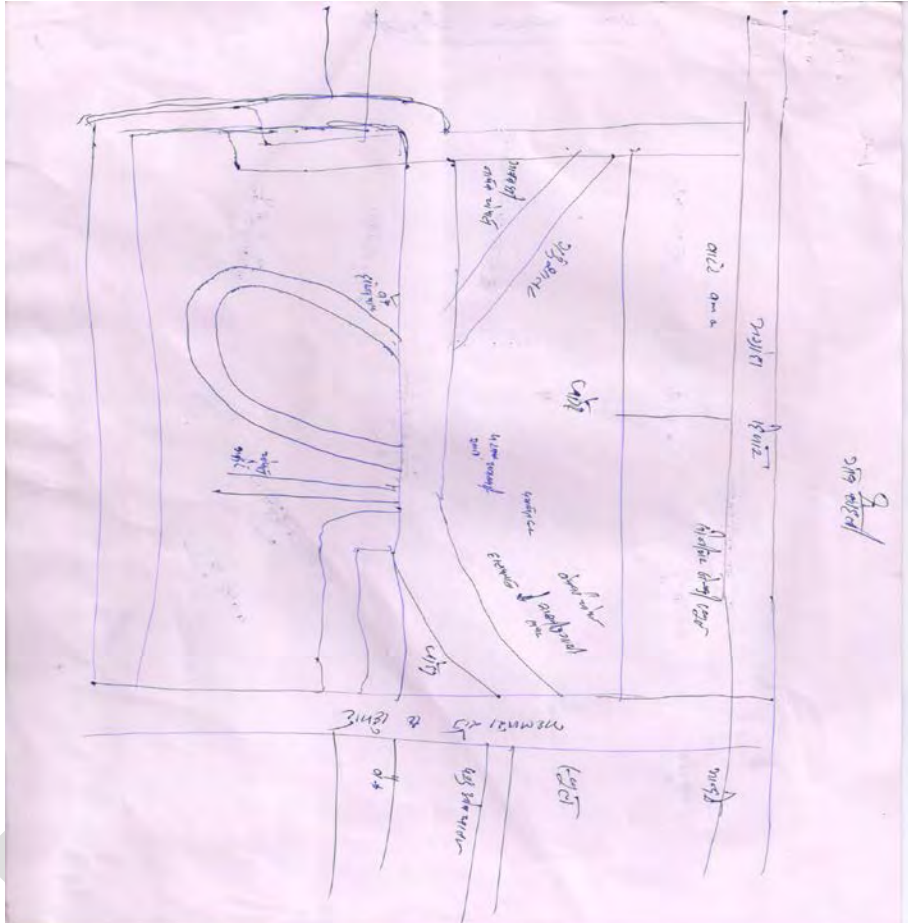

### 3.3. Community level Mitigation Programme

Include hazard specific mitigation measures and schemes running in the village

#### 3.3.1. Flood Mitigation

- Construction of flood shelter
- Drainage channels to be cleared
- Construction of raised platforms near important/ vulnerable areas, such as school, shelter of animals, gaushalas, etc.
- 
- 

#### 3.3.2. Earthquake Mitigation

- Detailed survey of buildings for assessment of damage and repair/ reconstruction and seismic strengthening or demolition
- Training the local masons for constructing earthquake resistant structures
- Conducting mock drills in villages for evacuation during an earthquake

- Fix all objects in houses that can fall and cause injury (non structural mitigation....)

- 
- 

### 3.3.3. Drought Mitigation

- Continuous drought monitoring through rainfall situation, water availability in reservoirs, rivers, canals, etc. and comparing with existing water needs of society.
- Water conservation through rainwater harvesting in houses and farmers' fields
- Allowing runoff water from all fields to a common point (eg: pond) or allowing it to infiltrate in the soil where it has fallen
- Generating awareness among the village people on implementing water conservation and agriculture awareness programs through television, pamphlets, nukkad natak, etc.

- 
- 

### 3.4. Schemes & Disaster Mitigation

The following schemes/ projects are running in the village and segregate them relevant to Mitigation and Preparedness measures :-

- NREGA( for flood protection works in the village
- IAY(earthquake resistance building also protecting from cold and heat waves)
- Pradhan Mantri Gram Sadak Yojana(for prompt response and resource mobilization)
- Rural Water Supply Programme
- Total Sanitation Campaign(preventing epidemic like situation)
- Rural Connectivity Programme(economic development of agriculture sector and allied activities in the villages)

## Chapter 4: Response Plan

**3.1 Village Disaster Management Committee :-** to carry out disaster management activities i.e. village disaster management plan, **training** and awareness activities, identification of resources and search & rescue activity at village level conducted by Village Disaster Management Committee. The following is the list of committee members:-

### Village Disaster Management Committee

Sr. No.	Name	Designation	Name	Contact No.
i.	<b>Sarpanch</b>	Chairman	Nirmla rani	9992152799
ii.	<b>Village Secy</b>	Nodal Officer	Devender singh	9416605862
iii.	<b>Patwari</b>	Member	Subhash chander	9416593769
iv.	<b>Numberdar</b>	Member	Amar singh	9992146328
v.	<b>SC Panch</b>	Member	Anita	9812641435
vi.	<b>BC Panch</b>	Member	Ranbir singh	9467161301
vii.	<b>Women (Mahila) Panch</b>	Member	Geeta	9416237324
viii.	<b>Anganwadi Worker</b>	Member	Amarpati	9728365487
ix.	<b>SHG</b>	Member	--	--
x.	<b>School Representation</b>	Member	Mahavir Dhaka	9466917221
xi.	<b>Ex Serviceman</b>	Member	Madan lal	9896285459
xii.				

1. Village Secretary is Nodal Officer for Disaster Management plan of respective village
2. VDMC will conduct meetings/ Gram Sabha for planning for Disaster Management Teams, HRVC and mitigation issues, preparedness issue, relief distribution sites, and rehabilitation plans other plan related issues.
3. Village Secy has prepared document the plan and VDMC has been approved the plan and submit it to the BDPO Office.
4. BDPO should make a copy of the plan and submit it to ADC Office after Compilation of the plans.
5. RO along with BDPO has conducted training program along with officers/ trainers from Fire Department/ Red Cross/ Revenue department/ civil defence.

### 3.2 Administrative control

<i>Designation</i>	<i>Contact Number</i>	<i>Contact Address</i>
<b>Deputy Commissioner</b>	<b>01662232045</b>	<b>Mini Sectt. Hisar</b>
<b>Deputy Commissioner</b>	<b>232045, 233928</b>	<b>Hisar</b>
<b>SP</b>	<b>01662-232307</b>	<b>Hisar</b>
<b>ADC</b>	<b>232692, 241035,</b>	<b>Hisar</b>
<b>SDM</b>	<b>232798</b>	<b>Hisar</b>
<b>ADO</b>	<b>9812688568</b>	<b>Umma Devi</b>
<b>BDPO</b>	<b>9996782602</b>	<b>Anil Kumar, Adampur</b>
<b>Village Secretary</b>	<b>9416605862</b>	<b>Mandi adampur</b>
<b>Gram Pradhan</b>	<b>9992152799</b>	<b>Kohli</b>
<b>BEO</b>	<b>01669-242261</b>	<b>Adampur</b>
<b>Fire Officer,</b>	<b>101, 275050</b>	<b>Hisar</b>
<b>SMO</b>	<b>256148</b>	<b>Dr. Roshan lal, Adampur</b>

### 3.3 Members of Village Disaster Management Teams (VDMT)

<b>S. No.</b>	<b>Name</b>	<b>Designation</b>	<b>Contact Number</b>	<b>Contact Address</b>
<b>Early Warning and Information Dissemination Team</b>				
1	Nirmla rani	<b>Sarpanch</b>	9992152799	Kohli
2	Shubhash	<b>Patwari</b>	9416593769	Mandi adampur
3	Devender singh	<b>Sachive</b>	9416605862	Mandi adampur
4	Amar singh	<b>Namberdar</b>	-	Kohli
<b>Evacuation Team</b>				
1	Madan lal	<b>Ex-servicman</b>	9896235459	Kohli
2	-	-	-	-
3	Anita devi	<b>Panch</b>	9812641435	Kohli

4	Radeshyam	<b>Panch</b>	9416141392	Kohli
5				
<b>Search and Rescue Team</b>				
1				
2	Madan lal	<b>Ex-Serviceman</b>	9896235459	Kohli
3	Anita devi	<b>Panch</b>	9812641435	Kohli
4	Radheshyam	<b>Panch</b>	9416141392	Kohli
	Rajkumar		9802890081	Kohli
<b>First Aid Team</b>				
1	Suresh kumar	ANM	9255490217	Kohli
2	Dharshana devi	Asha Worker		Kohli
3	Mukesh kumar	<b>RMP</b>	9812336141	Kohli
4	Rishala singh	<b>Medical</b>	9466005910	Kohli
<b>Relief Management Team</b>				
1	Nirmla rani	<b>Sarpanch</b>	9992152799	Kohli
2	Shubhash chander	<b>Patwari</b>	9416593769	Adampur
3	Rajender parkash saini	<b>Depu holder</b>	9416593521	Kohli
<b>Sanitation Team</b>				
1	Radheshyam	<b>Panch</b>	9416141392	Kohli
2	Dalip kumar	<b>Sweeper</b>	8684001905	Kohli
<b>Carcass Disposal Team</b>				
1	Dalip kumar	<b>Sweeper</b>	8684001905	Kohli
2	Radheshyam	<b>Panch</b>	9416141392	Kohli
<b>Shelter Management Team</b>				
1	Mahaveer Dhaka	<b>Headmaster</b>	9466917221	Kohli
2	Nirmla rani	<b>Sarpanch</b>	9992152799	Kohli
3				
<b>Damage &amp; Need Assessment Team</b>				
1	Nirmla rani	<b>Sarpanch</b>	9992152799	Kohli
2	Devender singh	<b>Gram sachiv</b>	9416605862	Mandi adampur

3	Shubhash chander	<b>Patwari</b>	9416593769	Adampur
4				
<b>Rehabilitation &amp; Reconstruction Team</b>				
1	Nirmla rani	<b>Sarpanch</b>	9992152799	Kohli
2				
3	Devender singh	<b>Sachive</b>	9416605862	Mandi Adampur
4	Shubhahs chander	<b>Patwari</b>	9416593769	Mandi Adampur

### 3.4 Contact Details of Emergency Resource Owners/ Practitioners [Private], elected Panches in the Village Panchayat:

No.	Name	Practise/Resource	Telephone No.	Mobile No.
1	Chanan Mal	Tractor	Adampur	86078018656
2	Surender kumar	Pick up	Adampur	9896442798

### 3.5 Village level Skilled persons

Name	Expertise	Address	Telephone #
Narshi	Mistri	Kohli	9813143782
Jagdish	Khati	Kohli	9467250157
Madan Lal	Ex Serviceman	Kohli	989625459
Mohan Lal	Sportsman	Kohli	9466216873
Madan lal	Swimmer	Kohli	--
Mukesh	Boxer	Kohli	9992107116s



# Chapter 5: Contact details & Updation Mechanism

---

## 5.1. Updation Mechanism

- Discussed with the village people about whose responsibility is it to update the plan.
- the VDMP will be updated regularly.
- It should be taken care that the VDMP should be simple otherwise it will not be understood, and disseminated else it will not reach the needful.
- The VDMP should be revised regularly otherwise it will not be up to date.